

THIS DRAWING CONTAINS INFORMATION PROPRIETARY TO RF INDUSTRIES.  
 ANY UNAUTHORIZED USE OF THIS DRAWING IS EXPRESSLY PROHIBITED  
 WITHOUT WRITTEN PERMISSION FROM RF INDUSTRIES.  
 ANY VIOLATION IS PUNISHABLE UNDER U.S. COPYRIGHT LAWS.

ALL DIMENSIONS ARE REFERENCE ONLY

PART NO.

# RMX-8000-B

REV	DESCRIPTION	DWN	DATE	APPROVED
A	ENGINEERING RELEASE	CZS	11/6/97	R. RICE
B	WAS RFX-8000-B NOW RMX-8000-B	KMM	3/6/99	R. RICE
C	CHANGE FORMAT, SPECS & DRAWING # FROM 8740	CZS	8/2/01	JDMc

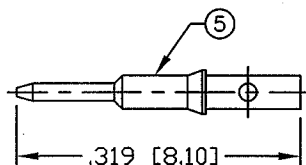
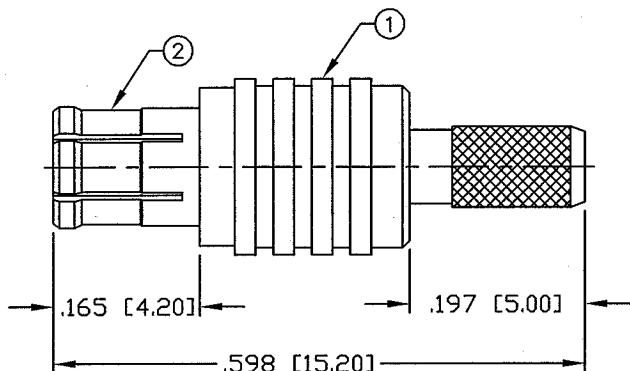

SOLDER PIN IS RECOMMENDED  
 TO CRIMP USE RFA-4089 CRIMP TOOL

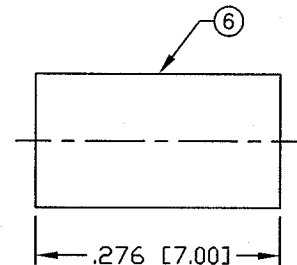

RECOMMENDED CRIMP DIE: 130

## SPECIFICATIONS:

IMPEDANCE: 50 Ohms  
 FREQUENCY RANGE: 0-6 GHz  
 WORKING VOLTAGE: 335 V rms @ sea level  
 VSWR: 1.3 MAX.  
 TEMPERATURE RANGE: -65°C TO 165°C  
 INSULATION RESISTANCE: 1k M Ohms min.

(B) FOR RG-174, 188, 188A, 316/U, ALPHA 9174, 9316,  
 BELDEN 8216, 83269, 83284, 84316 & TIMES LMR-100A CABLE

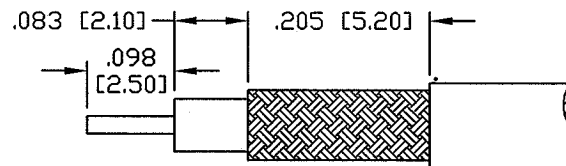

RECOMMENDED STRIPPING DIM'S

1	BODY	1	BRASS	NICKEL, 100μ"
2	MCX BODY	1	Be. Cu.	NICKEL, 100μ"
3	INSULATOR	1	PTFE	----
4	INSULATOR	1	PTFE	----
5	PIN	1	BRASS	GOLD, 30μ"
6	FERRULE	1	COPPER	NICKEL, 100μ"
7				
8				
9				
10				
11				
12				
13				
14				
#	DESCRIPTION	QTY	MATERIAL	FINISH

008974	
DRAWN C. ZUNIGA	8/2/01
CHECKED <i>[Signature]</i>	8-27-01
ORJ DRAWN C. ZUNIGA	11/6/97
APPROVALS	DATE

UNLESS OTHERWISE SPECIFIED:

- REMOVE ALL BURRS
- BREAK ALL CORNERS & EDGES .005 R. MAX.
- CHAMFER 1ST & LAST THREADS 45°
- SURFACE ROUGHNESS 63 FINISH MIL-STD-10
- DIAMETERS ON COMMON CENTERS TO BE CONCENTRIC WITHIN .002 T.I.R.
- ALL DIMENSIONS ARE AFTER PLATING.

DIMENSIONS ARE IN INCHES AND [MILLIMETERS]  
 UNLESS OTHERWISE NOTED TOLERANCES ARE:

DECIMALS	DIAMETER
.xxx±.003 [.08]	.xxx±.001 [.03]
.xx±.005 [.13]	.xx±.003 [.08]

7610 MIRAMAR RD  
 SAN DIEGO, CA 92126  
 (858) 549-6340  
 (858) 549-6345 FAX

## RF connectors

DIVISION OF RF INDUSTRIES, LTD.

# MCX PLUG, CRIMP

SIZE <b>A</b>	CABLE GROUP <b>B</b>	DWG NO. <b>RMX-8000-B</b>	REV <b>C</b>
SCALE: NTS		CAD FILE OUTLINE	SHEET 1 OF 1